



# QRD1000 T800

Multi-Tech card access control terminal.

QRD1000T800 is an RFID access control device running Linux operating system. Designed for outdoor use, waterproof with rugged metal housing and 2.5D tempered glass panel. IP65 rated against water and IK04 rated against vandalism.

Incorporates 2.4" color display and hidden touch keypad to enhance the unlocking experience without the need for physical contact.

It has a Multi-tech RFID module, compatible with 125kHz and 13.56MHz cards, including support for HID Prox and HID iClass. Compatible with push communication protocol. It has a Wiegand input port to connect a proximity reader and can function as an external reader for the controller using a Wiegand output port.

# QUALICA-RD QRD1000T800



## Technical Specifications

Display	2.4-inch TFT color LCD display
Operating system	Linux
Card capacity	50.000 (Optional 100.000)
Logging capacity	200.000 (Optional 1000.000)
User password	6 Digits
RFID	Standard Module: ID Multi-technology card optional module: Module 1 Supports ID&IC& DESFire EV1/EV2; Module 2 Compatible with ID&IC& DESFire EV1/EV2&Feliac&Legic&HID Prox; Module 3 Compatible with ID&IC& DESFire EV1/EV2&Feliac&Legic&HID Prox&HID iclass;
Communication	Wi-Fi, TCP/IP, Wiegand, RS485, OSDP (Ver2.1.7), RS232 (for printer only)
Wired network	10 / 100 Mbps, Auto MDI/MDI-X
Access control interface	Third-party electric lock, door sensor, exit button, alarm, door bell
Auxiliary interface	1 AUX input
Indication light	Breathing light White, Status light: Red / Green
Hardware	1GHz dual-core CPU, DDR2 64M, Flash 256M
Data protection	AES-256 encryption
Keypad	Concealed touch keyboard
Wiegand señal	Wiegand input / output
Standard functions	ID card, Web sever, Automatic status change, Self-service query, DST, 14-digit user ID, programmed ringing, Anti-passback, HTTPS, Protocol conversion (AC push to TA push)
Optional functions	Multi-technology card module, printer
Power supply	DC 12V 3A
Operating temperature	-10°C at 55°C (14°F a 131°F)
Operating humidity	10% at 90% HR
Dimensions	143*85*19,8 mm
Protocol	A & C Push (default) / T&A Push

## Configuration

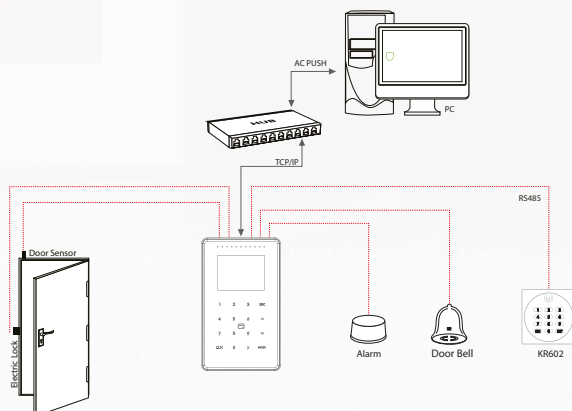

## Dimensions (mm)

